

Role of Digital Twin Technology of in enhancing Construction Project Lifecycle Management

Ar. Sainthavi¹, Ar. V. Vidya², Ar. Z. Fathima Taskeen³

¹Post Graduate Student, M.Arch - Construction project management student, Faculty of Architecture, Dr. M.G.R Educational and Research Institution, Chennai, India.

²Associate Professor, Faculty of Architecture, Dr .M.G.R Educational and Research Institution, Chennai, India.

³Additional HOD, Faculty of Architecture, Dr .M.G.R Educational and Research Institution, Chennai, India.

Abstract - The construction industry is undergoing a significant transformation with the adoption of advanced digital technologies. Among these, Digital Twin technology has emerged as a powerful tool for improving project lifecycle management. A Digital Twin represents a dynamic virtual model of a physical asset, integrating real-time data, design information, and operational parameters. This study explores the role of Digital Twin technology in enhancing various stages of the construction lifecycle, including planning, design, execution, and operation. The research highlights key benefits such as improved decision-making, real-time monitoring, enhanced collaboration, and optimized resource utilization. Additionally, challenges such as high implementation cost, data integration issues, and lack of standardization are discussed. The study concludes that Digital Twin technology has the potential to significantly improve construction efficiency, reduce risks, and support sustainable project delivery when effectively integrated with existing systems.

Key Words: Digital Twin, Construction Lifecycle, BIM, Real-time Monitoring, Project Management, IoT.

1. INTRODUCTION

The construction industry is characterized by complex processes, multiple stakeholders, and large volumes of data, making efficient project management a challenging task. With the advancement of digital technologies, there is a growing shift toward data-driven construction practices. One such emerging innovation is Digital Twin technology, which enables the creation of a dynamic virtual representation of a physical asset.

Digital Twin integrates multiple data sources such as design models, sensor inputs, scheduling information, and cost data into a unified digital environment. Unlike traditional static models, it continuously updates based on real-time conditions, allowing project stakeholders to monitor, analyze, and optimize project performance throughout its lifecycle.

Digital Twins function as a "living system" by combining BIM models, IoT data, and project management tools, thereby acting as a centralized source of information for all stakeholders.

This study aims to examine how Digital Twin technology enhances construction project lifecycle management by

improving coordination, decision-making, and operational efficiency across different project phases.

2. METHODOLOGY

Literature Review: Study of Digital Twin concepts, Building Information Modeling integration, and lifecycle management practices in construction.

Lifecycle Segmentation: Division of the project into planning, design, construction, operation, and redevelopment phases for structured analysis.

Digital Twin Framework Mapping: Identification of how Digital Twin integrates BIM, IoT, and data systems across each lifecycle stage.

Data Integration Analysis: Evaluation of real-time data flow between physical construction activities and digital models.

Comparative Assessment: Comparison between conventional construction management and Digital Twin-based approach using key parameters (time, cost, efficiency).

Simulation-Based Evaluation: Use of predictive modeling concepts to analyze delays, risks, and performance improvements.

Case Study Analysis: Interpretation of secondary case studies to validate Digital Twin effectiveness in real-world construction scenarios.

Performance Metrics Evaluation: Assessment based on indicators such as delay reduction, cost control, productivity, and error minimization.

Result Synthesis and Inference: Integration of all findings to evaluate the impact of Digital Twin on overall construction project lifecycle management.



Chart -1: Methodology Flowchart

3. DIGITAL TWIN TECHNOLOGY IN CONSTRUCTION

Digital Twin technology refers to a data-driven digital representation of a physical building or infrastructure asset that continuously interacts with real-world data. It combines multiple technologies such as Building Information Modeling (BIM), Internet of Things (IoT), artificial intelligence, and cloud computing to provide real-time insights into project performance.

According to the dissertation, Digital Twins are not merely 3D models but dynamic systems that integrate design data with operational data, enabling continuous simulation, monitoring, and lifecycle management.

In construction, Digital Twins play a critical role by: Providing real-time monitoring of project progress. Enhancing coordination among stakeholders. Enabling predictive analysis and simulation. Supporting data-driven decision-making.

4. CONSTRUCTION PROJECT LIFECYCLE AND DIGITAL TWIN APPLICATION

Digital Twin technology enhances all stages of the construction lifecycle:

Planning and Design Phase: Improves design accuracy through simulation. Enables clash detection and design optimization. Enhances visualization and stakeholder communication.

Construction Phase: Provides real-time tracking of site activities. Monitors resource utilization and productivity. Reduces delays through predictive analysis.

Operation and Maintenance Phase: Supports facility management through live data. Enables predictive maintenance. Improves asset performance and lifecycle cost management.

Demolition and Redevelopment Phase: Assists in data-driven decision-making. Supports sustainable material reuse strategies.

5. PROCESS OF IMPLEMENTING DIGITAL TWIN IN CONSTRUCTION PROJECT LIFECYCLE

The implementation of Digital Twin technology in construction involves the integration of multiple digital systems and real-time data sources to create a dynamic virtual representation of the project. The process typically includes the following stages:

Data Collection and Integration: Project data is gathered from various sources such as design drawings, schedules, cost estimates, and sensor inputs. This data is integrated into a centralized digital platform to ensure consistency and accessibility.

Development of Digital Model: A digital model is created using Building Information Modeling, which forms the

foundation of the Digital Twin. The model includes geometric, functional, and operational information of the project.

Integration with Real-Time Data Systems: Sensors and IoT devices are deployed on-site to collect real-time data related to construction activities, environmental conditions, and equipment performance.

Simulation and Analysis: The Digital Twin enables simulation of construction processes to predict potential issues, optimize scheduling, and improve decision-making.

Monitoring and Feedback Loop: Continuous monitoring of project performance allows for real-time updates to the digital model. Feedback from the Digital Twin supports corrective actions and process optimization.

6. ADVANTAGES OF DIGITAL TWIN TECHNOLOGY

Digital Twin technology offers significant advantages in improving construction project lifecycle management by enabling data-driven decision-making, real-time monitoring, and enhanced coordination across all project phases.

Enhanced Project Visualization and Understanding: Digital Twin provides a highly detailed and dynamic virtual representation of the physical asset, allowing stakeholders to visualize the project in real-time. Unlike traditional 2D drawings, it offers an interactive 3D environment that improves clarity in design interpretation and reduces misunderstandings among project participants.

Real-Time Monitoring and Control: By integrating IoT sensors and data systems, Digital Twins enable continuous tracking of construction activities, material usage, and site conditions. This real-time monitoring helps project managers identify deviations from planned schedules and take corrective actions immediately, thereby improving overall project control.

Improved Decision-Making: Digital Twin systems support data-driven decision-making by providing accurate and up-to-date information. Through simulation and predictive analysis, project managers can evaluate multiple scenarios and select the most efficient and cost-effective solutions.

Reduction in Project Delays and Cost Overruns: The ability to simulate construction processes and monitor real-time progress allows early identification of potential delays. This proactive approach helps in minimizing disruptions, avoiding rework, and controlling project costs effectively.

Enhanced Coordination and Collaboration: Digital Twin acts as a centralized platform where all stakeholders, including architects, engineers, contractors, and clients, can access and share project information. Integration with Building Information Modeling further improves coordination by ensuring that all parties work with consistent and updated data.

Efficient Resource Management: Digital Twin technology enables accurate tracking of materials, labor, and equipment.

This helps in optimizing resource allocation, reducing waste, and improving productivity on construction sites.

Predictive Maintenance and Risk Management: Through continuous data analysis, Digital Twins can predict potential failures in equipment or building components. This allows preventive maintenance, reducing downtime and improving safety. It also helps in identifying risks at an early stage and implementing mitigation strategies.

Improved Quality Control: Digital Twin systems allow continuous monitoring of construction quality by comparing real-time data with design specifications. This ensures that construction activities meet required standards and reduces the chances of defects.

Lifecycle Management and Facility Optimization: Digital Twin extends beyond construction into the operation and maintenance phase. It supports facility management by providing real-time insights into building performance, energy consumption, and system efficiency, thereby improving long-term asset management.

Support for Sustainable Construction Practices: Digital Twin enables simulation of energy usage, material efficiency, and environmental impact. This helps in adopting sustainable construction practices, reducing carbon footprint, and enhancing overall project sustainability.

7. DISADVANTAGES / CHALLENGES

Despite its benefits, the implementation of Digital Twin technology also presents certain challenges:

High initial investment and implementation cost. Requirement of advanced technical expertise. Complexity in integrating multiple data systems. Data security and privacy concerns. Lack of standardization across platforms. Resistance to adoption within traditional construction practices.

8. CASE STUDIES

1. Digital Twin Implementation in Construction – 51 Moorgate, London.
2. Digital Twin – Ameroro Dam Project, Indonesia.
3. Digital Twin in Smart Commercial Buildings.
4. Digital Twin in Smart Infrastructure Projects.

8.1 DIGITAL TWIN IMPLEMENTATION – 51 MOORGATE, LONDON

The 51 Moorgate project is a commercial office refurbishment located in London, UK. The project was executed by Skanska UK and involved upgrading a ten-story office building with a strong focus on sustainability and smart building integration. The project targeted high environmental performance standards including BREEAM Excellent and WELL Gold certifications. It is recognized as one of the early real-world applications of Digital Twin technology in commercial refurbishment projects.

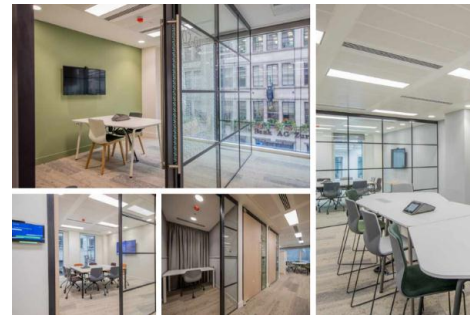

Fig -1: The 51 Moorgate project

Objective of Digital Twin Adoption: Improve energy efficiency of building systems. Enable predictive maintenance for facility management. Create a real-time digital replica of building assets. Integrate IoT sensors with BIM for continuous monitoring. Enhance occupant comfort and building performance.

The project adopted a structured Digital Twin implementation approach combining BIM, IoT, and cloud-based platforms:

- **Scan-to-BIM:** Laser scanning used to create accurate as-built model
- **BIM Platform:** Autodesk Revit for model development
- **Digital Twin Platform:** Intellect (Skanska) for real-time integration
- **IoT Sensors:** Installed in HVAC, lighting, and occupancy systems

Workflow Process: Data capture using laser scanning. Integration of architectural and MEP models. Installation of IoT sensors. Real-time data connection to Digital Twin dashboard. Use of dashboard for facility management and monitoring

This case study demonstrates that Digital Twin technology significantly enhances building performance by enabling real-time monitoring and predictive decision-making. The integration of BIM and IoT allows efficient lifecycle management, while project management ensures successful implementation. Despite higher initial costs, long-term operational benefits justify adoption.

8.2 DIGITAL TWIN – AMERORO DAM PROJECT, INDONESIA

The Ameroro Dam project is a large-scale infrastructure development in South Sulawesi, Indonesia. It is a multipurpose dam project aimed at irrigation, flood control, and hydroelectric power generation. The project is notable as one of the first infrastructure projects in Indonesia to implement Digital Twin technology for construction and lifecycle management.



Fig -2: Project Information Data Processing



Fig -4: Digital Twin technology in Football Stadium

Objective of Digital Twin Adoption: Improve construction progress tracking. Enable real-time monitoring of site activities. Provide decision-support system for project managers. Enhance transparency among stakeholders. Prepare structured data for lifecycle management.

Methodology / Implementation: The project utilized a Digital Twin system integrated with PMIS and BIM - Digital Twin Platform: Autodesk Tandem. Data Sources.

- BIM models
- IoT sensors (water levels, structural health)
- Project schedules and cost data

PMIS Dashboard: Integrated system showing Gantt charts, maps, and KPIs.

Objective & Methodology: The primary objective of implementing Digital Twin technology in smart commercial buildings is to enhance building performance through real-time monitoring, energy optimization, and predictive maintenance. The system aims to reduce operational inefficiencies by continuously tracking building systems such as HVAC, lighting, and occupancy patterns, while also improving occupant comfort and space utilization. Additionally, Digital Twins support data-driven decision-making by providing facility managers with accurate and up-to-date information on building performance throughout its lifecycle.

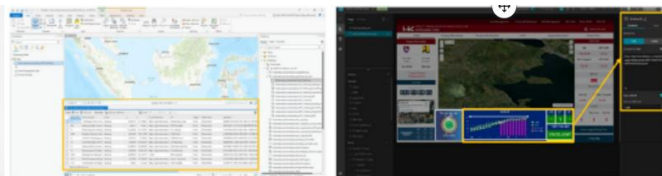

Fig -3: Project Performance Data Processing (PMIS Dashboard)

Workflow: Field data collection (progress, photos, QA/QC data). Data integration with geospatial mapping. Dashboard visualization of progress. Real-time analysis and alerts. Decision-making and reporting.

The Ameroro Dam project highlights the effectiveness of Digital Twin technology in large-scale infrastructure projects. It improves project monitoring, enhances transparency, and supports proactive decision-making. The integration of PMIS and Digital Twin significantly improves project lifecycle management.

8.3 DIGITAL TWIN IN SMART COMMERCIAL BUILDINGS

Digital Twin technology is widely used in modern commercial buildings for energy management, maintenance, and operational optimization. These buildings integrate BIM models with IoT sensors to create a live digital representation of building performance.

To achieve these objectives, a comprehensive methodology is adopted that integrates Building Information Modelling (BIM) with Internet of Things (IoT) sensors and advanced data analytics. Initially, a detailed BIM model is developed to represent the physical and functional characteristics of the building. IoT sensors are then installed across key systems to collect real-time data related to energy consumption, temperature, occupancy, and equipment performance. This data is continuously fed into a centralized Digital Twin platform, where it is processed and visualized through interactive dashboards. Advanced analytics and machine learning algorithms are applied to predict system behavior, identify inefficiencies, and enable proactive maintenance strategies. The integration of these technologies ensures a dynamic and continuously updated digital replica of the building, facilitating efficient lifecycle management and improved operational performance.

Digital Twin technology in commercial buildings enables efficient facility management and reduces operational costs. It provides a data-driven approach to building management, improving overall performance.

8.4 DIGITAL TWIN IN SMART INFRASTRUCTURE PROJECTS

Digital Twin technology in smart infrastructure projects provides a dynamic virtual representation of assets such as dams, bridges, and transportation systems, enabling real-time monitoring and lifecycle management. It integrates BIM models with IoT sensors to capture data related to structural performance, environmental conditions, and construction progress. This allows project teams to track site activities, identify potential risks, and make informed decisions at early

stages. The technology enhances coordination among stakeholders by providing a centralized data platform with visual dashboards. It also supports predictive maintenance by detecting issues before failure occurs, improving safety and reliability. Additionally, Digital Twins help optimize resource utilization and reduce delays during construction. Overall, it transforms traditional infrastructure management into a data-driven and efficient process.

Objective & Methodology: The primary objective of implementing Digital Twin technology in smart infrastructure projects is to enhance project monitoring, improve structural performance, and enable efficient lifecycle management through real-time data integration. It aims to support project managers in tracking construction progress, identifying potential risks, and optimizing resource utilization while ensuring safety and quality standards. Additionally, Digital Twins facilitate predictive maintenance by continuously analyzing structural behavior and environmental conditions, thereby reducing unexpected failures and improving long-term asset reliability. The technology also promotes transparency and coordination among stakeholders by providing a unified platform for data sharing and decision-making.

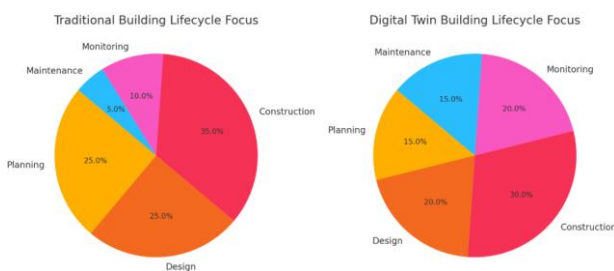

Chart -2: Traditional vs Digital Twin Building

To achieve these objectives, a systematic methodology is adopted that integrates Building Information Modelling (BIM), geospatial mapping, and IoT-based monitoring systems. Initially, a detailed digital model of the infrastructure is developed using BIM, incorporating design, structural, and construction data. IoT sensors are then deployed across critical components to capture real-time data such as load conditions, vibration, temperature, and environmental factors. This data is integrated into a centralized Digital Twin platform, where it is visualized through dashboards and linked with project management systems such as scheduling and cost tracking tools. Advanced analytics are applied to monitor performance trends, detect anomalies, and generate early warnings for potential risks. The continuous feedback loop between physical assets and the digital model ensures accurate monitoring, improved decision-making, and efficient management throughout the project lifecycle.

The case study indicates that Digital Twin technology significantly enhances infrastructure project performance by

enabling real-time monitoring and proactive decision-making. It improves risk management through early detection of structural and environmental issues, reducing delays and unexpected failures. The integration of BIM, IoT, and analytics ensures better coordination among stakeholders and more efficient resource utilization. Additionally, Digital Twins support long-term asset management by enabling predictive maintenance strategies. Overall, the technology transforms infrastructure projects into data-driven systems, improving efficiency, safety, and lifecycle performance.

9. OVERALL CASE STUDY INFERENCE

The overall analysis of the case studies demonstrates that Digital Twin technology plays a transformative role in enhancing construction project lifecycle management across both building and infrastructure projects. It enables real-time monitoring, accurate progress tracking, and data-driven decision-making, which significantly improves project efficiency and reduces delays. The integration of BIM, IoT, and digital platforms enhances stakeholder coordination and ensures better transparency throughout the project lifecycle.

Furthermore, the case studies highlight measurable improvements in energy efficiency, resource utilization, and facility management through predictive maintenance and continuous performance monitoring. Digital Twins also support risk management by identifying potential issues at early stages, thereby minimizing cost overruns and operational disruptions.

However, challenges such as high initial investment, data integration complexity, and the need for skilled professionals must be addressed for wider adoption. Overall, Digital Twin technology proves to be a powerful tool in delivering smarter, more efficient, and sustainable construction projects, aligning with modern project management practices and future-ready infrastructure development.

10. FINDINGS

Based on the analysis of Digital Twin technology across the construction project lifecycle and the case study evaluation, several key findings have been identified:

Improved Project Visibility and Transparency: Digital Twin technology provides a centralized digital environment where all project data is continuously updated and accessible. This improves transparency in project progress, enabling stakeholders to clearly understand the current status of construction activities at any stage.

Enhanced Decision-Making through Data Integration: The integration of design data, real-time site information, and scheduling systems allows project managers to make

informed decisions. The ability to simulate various scenarios helps in selecting optimal construction strategies and minimizing uncertainties.

Significant Reduction in Time Delays: Real-time monitoring and predictive analysis enable early identification of delays and bottlenecks. This allows project teams to take corrective actions in advance, resulting in better adherence to project timelines.

Effective Cost Control and Resource Optimization: Digital Twin facilitates accurate tracking of materials, labor, and equipment usage. This leads to efficient resource allocation, reduction in wastage, and improved cost management throughout the project lifecycle.

Improved Coordination and Collaboration: The integration of Building Information Modeling with Digital Twin enhances coordination among stakeholders. A unified digital platform ensures that all participants work with consistent and updated information, reducing conflicts and miscommunication.

Early Risk Identification and Mitigation: Digital Twin enables predictive analysis of potential risks related to construction activities, equipment performance, and environmental conditions. This proactive approach helps in minimizing project uncertainties and improving safety.

Enhanced Quality Control Mechanisms: Continuous comparison between the digital model and actual construction progress ensures compliance with design specifications. This reduces errors, rework, and quality deviations.

Challenges in Implementation and Adoption: Despite its advantages, the adoption of Digital Twin technology is limited by factors such as high initial cost, lack of technical expertise, data integration complexity, and resistance to change within the construction industry.

11. CONCLUSION

Digital Twin technology represents a significant advancement in construction project management by enabling a data-driven and integrated approach to managing the entire project lifecycle. Unlike traditional methods, which rely on static data and periodic monitoring, Digital Twin provides a dynamic and continuously evolving digital representation of physical assets.

The study demonstrates that Digital Twin technology enhances project performance by improving visualization, enabling real-time monitoring, and supporting predictive analysis. Its integration with BIM, IoT, and project management systems allows for better coordination, efficient resource utilization, and improved decision-making.

Furthermore, the application of Digital Twin extends beyond the construction phase into operation and maintenance, making it a valuable tool for long-term asset management. The ability to simulate, monitor, and optimize building performance contributes to sustainable construction practices and improved lifecycle efficiency.

However, the widespread adoption of Digital Twin technology is still constrained by challenges such as high implementation costs, technical complexity, and lack of standardization. Addressing these challenges requires investment in digital infrastructure, training, and industry-wide collaboration.

Overall, Digital Twin technology has the potential to transform construction project lifecycle management by increasing efficiency, reducing risks, and enhancing project outcomes. Its adoption is expected to grow as the construction industry continues to move toward digital transformation.

12. RECOMMENDATIONS

Based on the findings and analysis, the following recommendations are proposed for effective implementation of Digital Twin technology in construction projects:

Adoption of Standardized Frameworks: Industry-wide standards and guidelines should be developed to ensure consistency in Digital Twin implementation. Standardization will facilitate better integration between different software platforms and improve interoperability.

Investment in Digital Infrastructure: Construction organizations should invest in advanced technologies such as IoT devices, cloud computing, and data management systems to support Digital Twin applications.

Training and Skill Development: Professionals in the construction industry should be trained in digital tools and technologies. Enhancing technical expertise is essential for the successful adoption and operation of Digital Twin systems.

Integration with Existing Systems: Digital Twin should be integrated with existing tools such as Building Information Modeling, scheduling software, and project management platforms to ensure seamless data flow and improved efficiency.

Implementation through Pilot Projects: Organizations should initially implement Digital Twin technology in pilot projects to evaluate its effectiveness and identify potential challenges before large-scale adoption.

Focus on Data Management and Security: Proper data governance policies should be established to ensure data

accuracy, security, and privacy. Reliable data management is critical for the success of Digital Twin systems.

Encouragement of Research and Innovation: Academic institutions and industry professionals should collaborate to explore new applications of Digital Twin technology, particularly in areas such as sustainability, smart infrastructure, and facility management.

Government and Industry Support: Government initiatives and industry support can play a key role in promoting the adoption of Digital Twin technology by providing funding, policies, and incentives for digital transformation in construction.

13. REFERENCES

- [1] Michael Grieves, "Digital Twin: Manufacturing Excellence through Virtual Factory Replication," White Paper, 2014.
- [2] National Aeronautics and Space Administration, "Digital Twin Definition and Applications in Engineering Systems," NASA Reports, 2012.
- [3] Fei Tao, and Meng Zhang, "Digital Twin Shop-Floor: A New Paradigm for Smart Manufacturing," IEEE Access, 2017.
- [4] Autodesk, "The Role of Digital Twins in Construction and Infrastructure," Autodesk Industry Report, 2020.
- [5] McKinsey & Company, "Digital Transformation in Construction: The Role of Advanced Technologies," McKinsey Report, 2019.
- [6] World Economic Forum, "Shaping the Future of Construction: Digital Twin and Smart Infrastructure," 2018.
- [7] Construction Project Management, by K. K. Chitkara, Tata McGraw Hill Education, India.
- [8] Building Information Modeling (BIM) and Digital Twin integration studies, various journal publications in Automation in Construction Journal.
- [9] International Organization for Standardization, ISO 19650: Organization and digitization of information about buildings and civil engineering works, 2018.
- [10] Deloitte, "Digital Twin Applications in Engineering and Construction Industry," Deloitte Insights Report, 2020.